

Linear 661



Nice G.O.
Smart
Connected



Smart Garage Door Operator

EN - Quick Start Guide

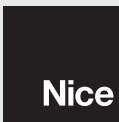

Attaching the Rail



Align the rail (a) over the center of the operator head (b).

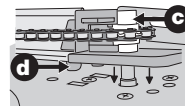

Slide the sprocket onto the shaft (c). Tabs should fit into the slots (d).

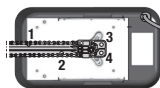

Attach the rail to the operator head by installing four 1/4"-20 x 11/16" bolts.

Tighten the four bolts with a 7/16" socket.

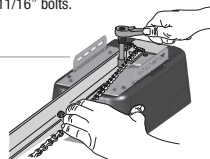

Hanging the Operator

The hanging brackets should be angled to provide rigid support. (a)

Adjust the operator and wall mounting bracket height so that it is relatively level, and there is a 1.75" gap between the rail and the high point of the door travel (b).

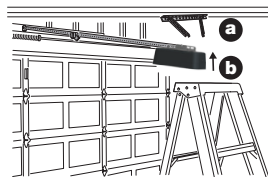

Attach operator to hanging brackets using two 5/16-18 x 1" hex bolts and two 5/16-18 keps nuts (supplied). (c)

Insert bolts from the inside of hanger brackets with the nuts on the outside of the operator, and then tighten nuts with a 1/2" socket. (d)

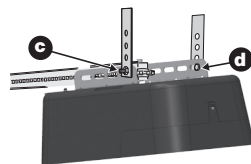

2

Wire / Mount the Wall Station

Strip back 1/2" of insulation, and connect a wire to each of the two terminals on the back of the wall station. Polarity does not matter. (a)

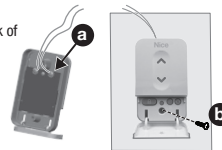

Mount the first screw in the location desired, then hang the Wall Station. Securely mount the Wall Station with the bottom screw. (b)

Connect either wire to the operator's WALL STATION terminal and the other wire to the operator's COMMON terminal. Polarity does not matter. (c)

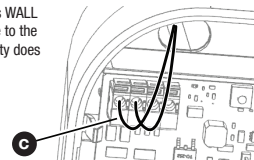

Install the Safety Beam

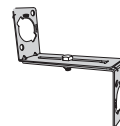

Assemble the two safety L-shaped brackets using two 1/4"-20 x 11/16" bolts and 1/4"-20 keps nuts.

Position and mount assembled brackets on each side of the door so the center line of the safety beam lenses will be 5-1/2" above the floor. Use the index marks on the brackets to make the bracket assemblies equal lengths.

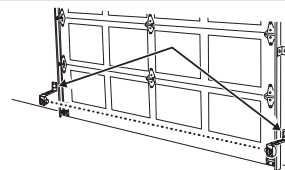

Insert the sender and receiver into the bracket holes so the lenses of the units will face each other (a).

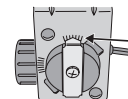
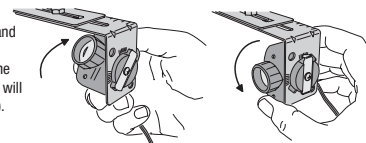

Twist the units until the spring clips lock into a detent mark on the brackets.

3

Route Beam Wires to the Operator (Non-prewired Installation)

Route and secure the wires from the sender and receiver back to the operator head.

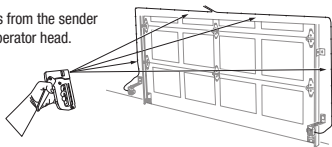

Wiring the Beams to the Operator

Attach either twisted connection to the operator's BEAM terminal. Connect the other twisted connection to the operator's COMMON terminal.

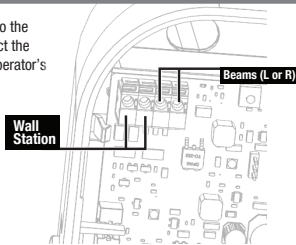

NOTE: Route wires away from the LED lights.

Install the Power Supply and Optional Mounting Bracket

Connect the power wires to the terminals (either wire to either terminal).

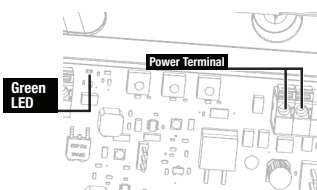

Install the Power Supply and Optional Mounting Bracket

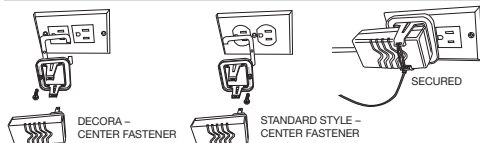

Spread the ears of the optional retaining bracket apart, and then plug the power supply into the outlet. The included zip tie can be used to secure the mounting ears together.

Adjusting the Open and Close Limits

NOTE: The operator is preset on its close limit and the open limit is preset for a 7-foot high door.

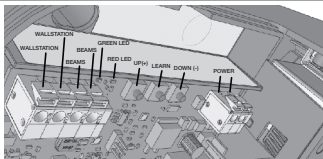

OPEN LIMIT (optional):

Press both the UP and LEARN buttons for three seconds. The operator will beep and flash two times. Press the UP or DOWN buttons to jog the operator to the open limit position. Press the LEARN button to store the setting, two long beeps for confirmation, and exit setup.

CLOSE LIMIT (optional):

Press both the DOWN and LEARN buttons for three seconds. The operator will beep and flash two times.

Press the UP or DOWN buttons to jog the operator to the closed limit position. Press the LEARN button to store the setting, two long beeps for confirmation, and exit setup.

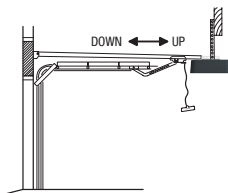

Automatic Door Force Setup

Setup the Safety Reversal System

Be sure that the trolley latch is up, and the door is connected to the operator.

After limits have been set, the learning process will be complete after the fourth cycle.



Nice G.O. Homeowner Smartphone App Installation

Download, Register and Activate Application

Use the homeowner's smartphone to visit the app store to download and install the Nice G.O. application. On initial use, you'll be asked to register and create their account. Once completed, sign in with the new account information.



Scan to download the app.



Connect the Opener to the Nice G.O. app

Using the Nice G.O. app on your mobile device, tap the plus sign at the bottom right of screen to Connect Your Device. Follow directions in app to Connect Your Device.

Adding a Transmitter or Keypad Code



Press & release LEARN button



Red LED will light for 15 seconds (ready to Learn)



Push Transmitter button or enter Keypad Code



1 flash = Transmitter button or Keypad Code learned

Erasing a Transmitter or Keypad Code



Press & release LEARN button



Red LED will light for 15 seconds (ready to Learn)



Push Transmitter button or enter Keypad Code



4 flashes = Transmitter button or Keypad Code erased

Erasing All Transmitters or Keypads



Press LEARN button for 10 seconds



3 flashes = All Transmitters & Keypads erased

Customer Service

(800) 421-1587
M - F, 8am - 7pm EST

Nice North America LLC

5919 Sea Otter Place, Suite 100
Carlsbad, CA 92010

Niceforyou.com

©2024 Nice North America LLC. Linear is a registered trademark of Nice North America LLC. All rights reserved.

Nice